

20 000 782

- hole diameter 32 mm
- rosette 60 x 60 mm
- with cold marking



|   |                                     |               |
|---|-------------------------------------|---------------|
|  | Dark Chrome                         | 20 000 782-19 |
|  | Chrome                              | 20 000 782-00 |
|  | Brushed Platinum                    | 20 000 782-06 |
|  | Platinum                            | 20 000 782-08 |
|  | Brushed Durabronze<br>(23kt Gold)   | 20 000 782-28 |
|  | Brushed<br>Champagne (22kt<br>Gold) | 20 000 782-46 |
|  | Champagne (22kt<br>Gold)            | 20 000 782-47 |
|  | Brushed Dark<br>Platinum            | 20 000 782-99 |

20 000 782

mm [inches]

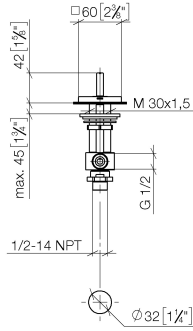

**Flow rate chart**



**Certificates**

WRAS\_2103001.

20 000 782

Parts for other finishes can be found here: [Chrome](#)

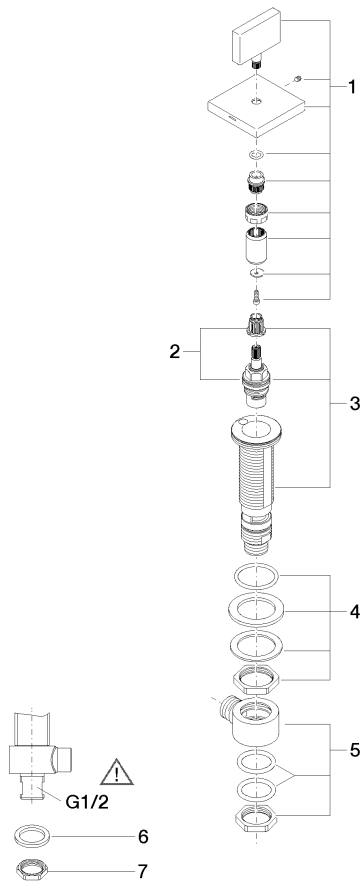

**Spare parts list**

| No. | Item Number        | Name            | Quantity used | Delivery time |
|-----|--------------------|-----------------|---------------|---------------|
| 1   | 90 20 78 002 04-19 | handle ( cold ) | 1             | 20            |
| 2   | 90 90 03 133 00 90 | top             | 1             | 2             |
| 3   | 04 17 11 058 33 90 | side panel      | 1             | 2             |
| 4   | 04 23 10 032 78 90 | fixing set      | 1             | 2             |
| 5   | 04 17 11 023 10 90 | distributor     | 1             | 2             |
| 6   | 09 30 11 059 90    | disc            | 1             | 2             |
| 7   | 09 23 10 012 90    | nut             | 1             | 2             |